

LAKE SURVEY MAP OF ELK LAKE

Sec. 7, 18, T37N, R1E
Town of Worcester
Price County

Area: 84 acres
Maximum depth: 21 feet
Average depth: 7 feet

TOPOGRAPHIC SYMBOLS

Dwelling:
Resort:
Bench Mark: BM

LAKE BOTTOM SYMBOLS

Peat: P
Muck: Mk
Clay: C
Sand: Sd
Gravel: Gr
Rubble: R
Weed Bed:
Rocky Shoal:

Water quality: medium brown stained water
slightly acid (pH = 6.8)
infertile and soft (alkalinity = 32 ppm)

Latest survey: 1970

Species	No.	Size Range	Rel. Abund.
Walleye	268	4.5 - 26.4	Common
Muskellunge	14	9.9 - 27.9	Present
Smallmouth bass	2	9.4 - 11.9	Rare
Crappie, rock bass			Common
Perch			Present

Basic management: walleye, musky, panfish.
General comments: an expanding northern pike
population exists. Panfish numbers in general are
low.

Shocking survey information furnished by Garry Bever, Area Fish
Manager, DNR. For further data interpretation, call 715-762-3205

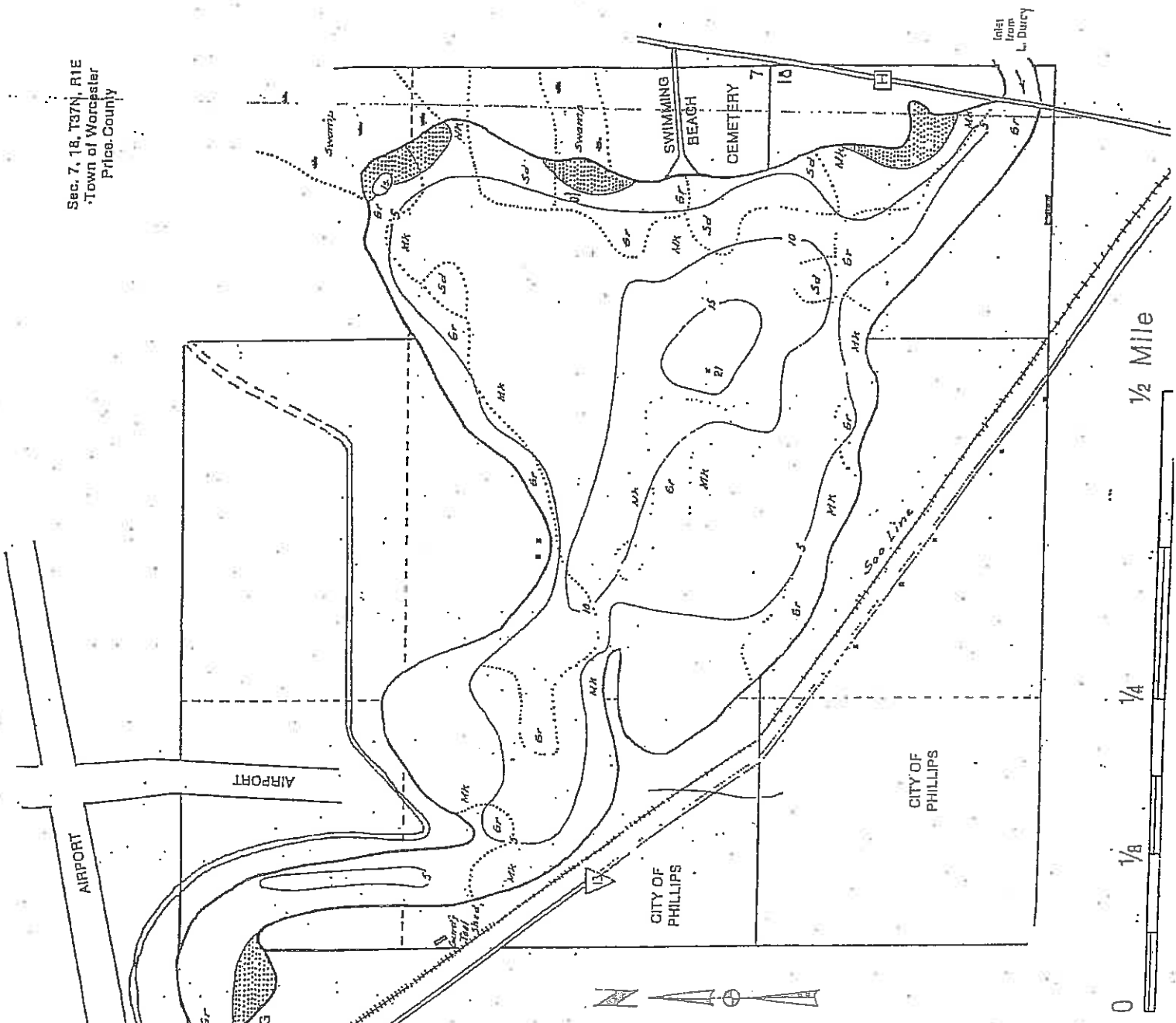

Compliments of
PRICE COUNTY RECREATION COMMITTEE
Box L4, Normal Building, Phillips, WI 54555